



WT65-wg

Rocker pushbutton

Rocker pushbutton, 1 NO contact 10 A/250 V AC. Pushbutton for single mounting 84x84x22 mm or mounting into the E-design switching system.

The scope of supply comprises the frame R1E, one rocker, an attachment frame and the rocker switch insert.

The rocker pushbutton with VDE sign has plug-in terminals.

Alternatively to claw fixing, screw fixing is also available for 55 mm switch boxes with stainless steel countersunk screws 2.9x25 mm, DIN 7982 C. See Accessories, Chapter Z.

Installation: Fit rocker pushbutton, fix frame using attachment frame and plug on rocker.

Typical connection

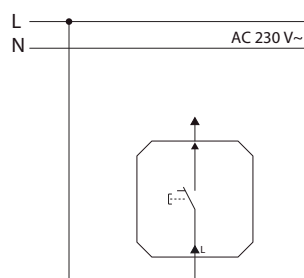

Rockers laser engraved page 8-13.

WT65-wg	Rocker pushbutton, pure white glossy	EAN 4010312317334	12,20 €/pc.
---------	--------------------------------------	-------------------	-------------